

TYK+ 10 ELL



Part number	3107292
Lampholder:	LED
Light Source:	LED
Wattage:	7 W
Finish:	AN-96 / Anthracite gray / Textured
Insulation class:	I
Degree of protection:	IP66
IK-J-xxIP:	IK06 1.2J xx3
CRI:	80
Kelvin:	4000
Power factor:	$\text{COS}\phi \geq 0,9$
Optic:	Elliptical reflector
Optic Beam:	$9^\circ \times 70^\circ$
Lightsource lumen output:	700 lm
Luminaire lumen output:	473 lm
L:	L90
B:	B10
Lifetime:	75000 h
Glass temperature:	55°
Ta MIN luminaire:	-20°
Ta MAX luminaire:	40°
ULR:	0%



Description

- LED floodlight for indoor and outdoor lighting, comprising:
- Die-cast aluminium housing, powder-polyester coated ISO 9227
 - Extra-clear, tempered, flat glass diffuser, screen-printed inside
 - Diffuser permanently sealed to the housing through a high-temperature resistant silicone
 - High-transparency polycarbonate lenses grant an optimized light transmission
 - Elliptical lens
 - High resiliency anti-ageing silicone gasket with high elastic return capacity
 - Tear-proof nickelled brass cable gland M16x1.5 for cables \varnothing 5 mm- \varnothing 10 mm
 - Stainless steel external screws
 - Stainless steel wall-mounting bracket
 - Complete with 1 metre of cable H05RN-F 3G1 mm²
 - Graduated goniometer for aiming purposes made in stainless steel
 - Photometric data measure according to UNI EN 13032-4 and IES LM-79-08

Photometric data

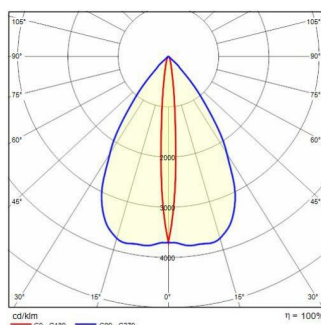

Technical drawings

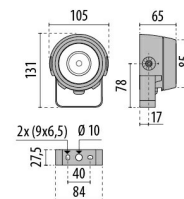

OPTIONAL ACCESSORIES

TYK+ 10



700191
Ground spike
Black

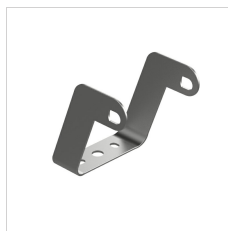

3108556
Extra rotation bracket +25°/-90°
Stainless steel